

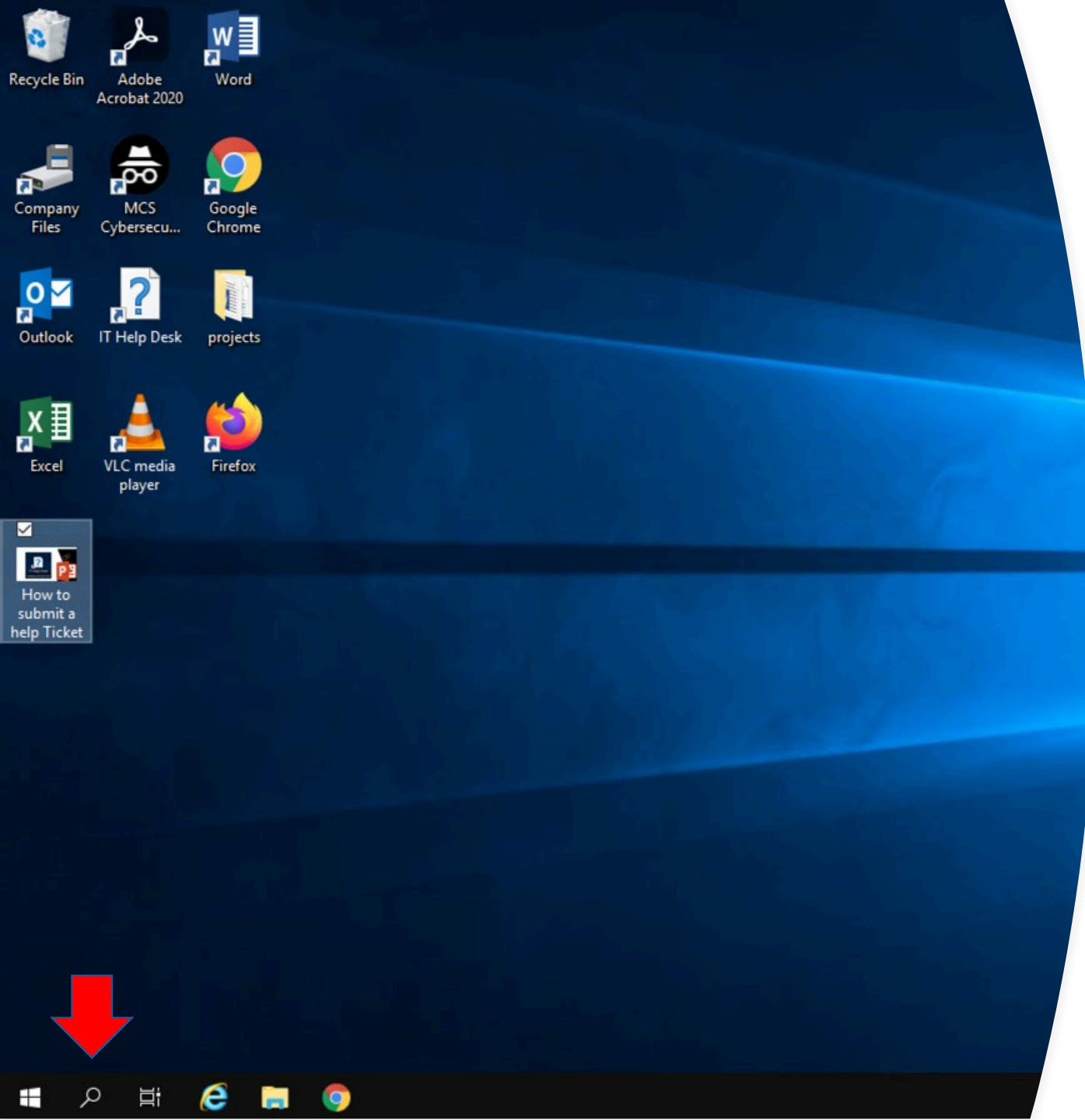

Changing your default Internet Settings





On your Desktop Click on the little magnifying glass in the bottom left corner.

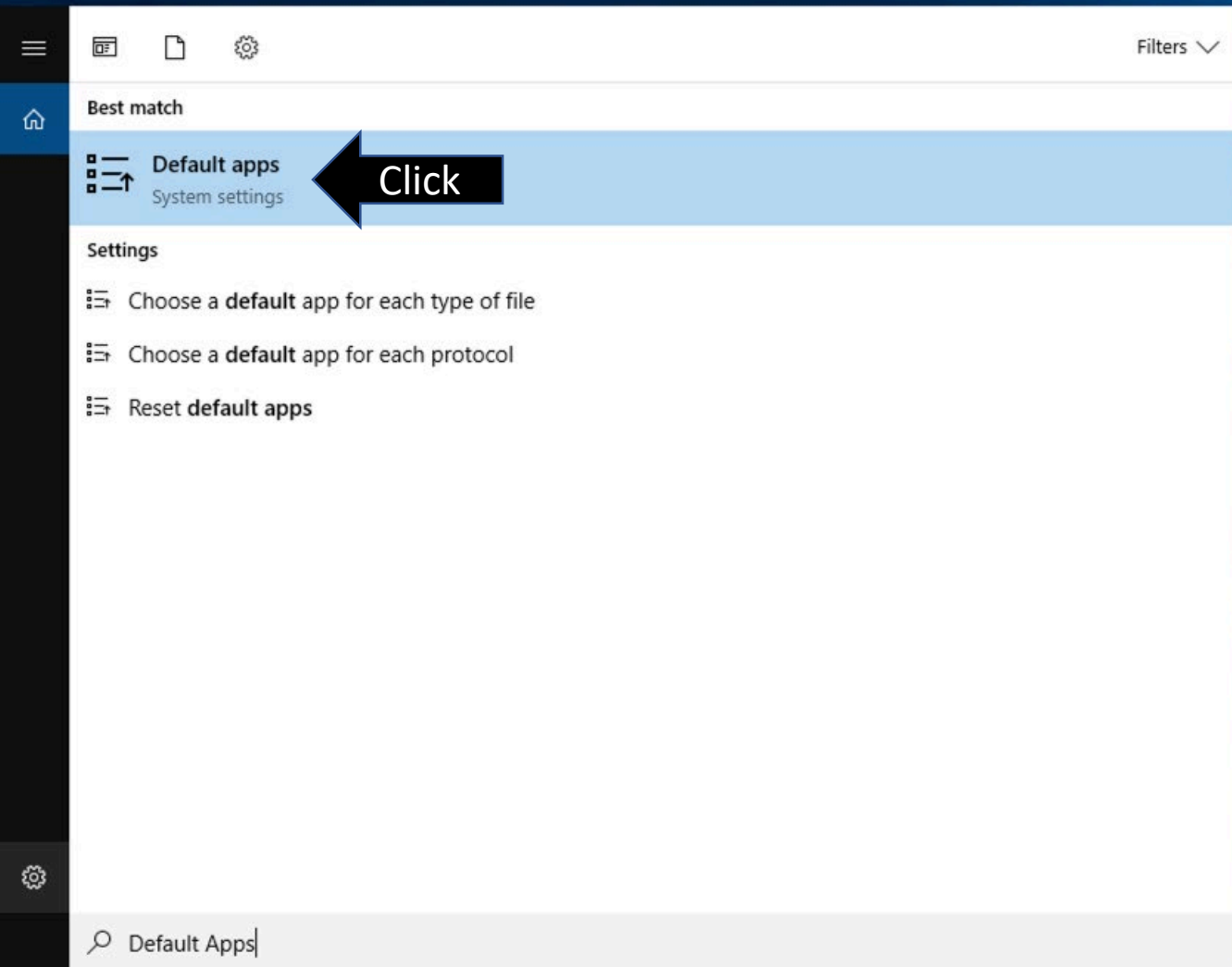

Type in "Default apps" in the search bar and click on the system setting.

Default apps

Choose default apps

Email

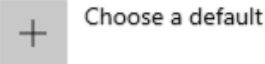

Maps

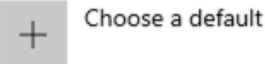

Music player

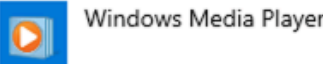
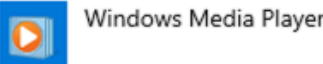

Photo viewer



Video player



Web browser



Look for the setting "web browser" and click the Internet Icon.

Default apps

Choose default apps

Email

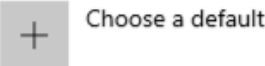

Maps

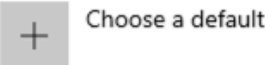

Music player

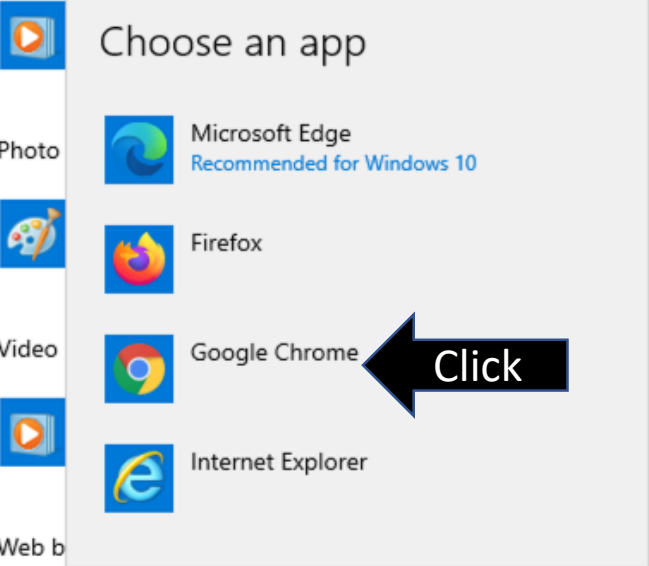
A grey menu titled "Choose an app" with a play button icon on the left. It lists four options: "Photo" with Microsoft Edge (Recommended for Windows 10), "Video" with Google Chrome, and "Web b" with Internet Explorer. A black arrow labeled "Click" points to the Google Chrome option.

Category	App
Photo	Microsoft Edge <i>Recommended for Windows 10</i>
Video	Google Chrome
Web b	Internet Explorer



With "Choose an App" menu open, click on Google Chrome. Google chrome is useable with all MCS related tasks.

Default apps

Choose default apps

Email



Choose a default

Maps



Choose a default

Music player



Windows Media Player

Photo viewer



Paint

Video player



Windows Media Player

Web browser



Google Chrome

Congratulations you have successfully changed your default Web browser.